



Car Parking Policy

Name of School:

Fatima Elizabeth Phrontistery

Car Parking Policy

Car parking at the madrasah is on a first come first served basis. At the **Walthamstow Academy** site there are two ways you may drop off your child/ren:

1. **The Pick & Drop Off car park off Academy Way** (*please see illustrations p.2*): This is the quickest and most efficient way to drop off your child/ren, there will be a member of staff by the gates, once your child is being escorted to the MUGA by a member of staff you may exit the Pick & Drop carpark. You **cannot** park longer than **5 minutes** in this carpark.
2. **The Main Car Park:** Parents may park their cars here and escort their child/ren to the MUGA or for coffee morning; parents' meeting; archery club etc. There is no time restriction for parking here.

Please ensure the safety of all carpark users as the site is used by many other organizations and at times the carpark may be heavily congested. There may be occasions where we will not be allowed to use the car park but we will inform you via WhatsApp prior to such an event. There will also be Hockey matches at times and again the carpark maybe full or congested upon arrival.

Alternatively, we suggest and promote our students to walk and cycle to madrasah as there is ample bike lockup spaces.

If you have any queries regarding this policy, please contact the Head Teacher Ustadh Hamid Mahmood

Student Drop off & Pick up at FEP

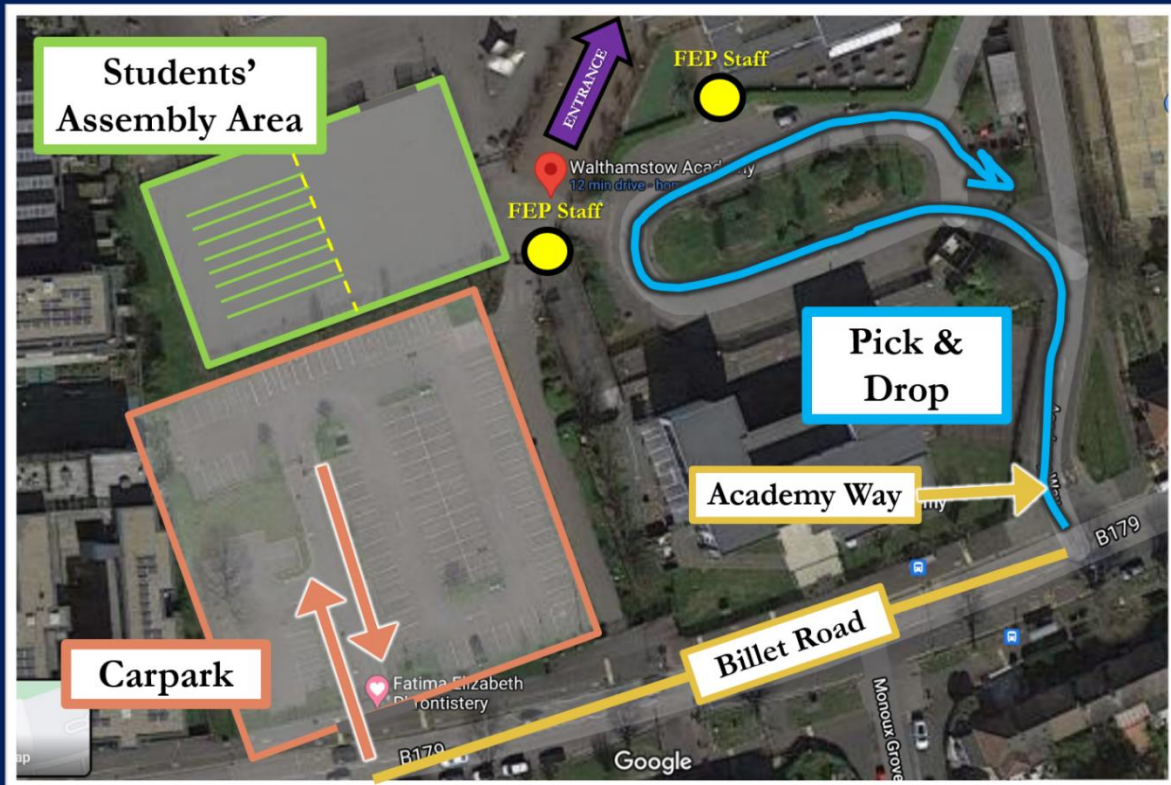

Student Drop off & Pick up at FEP

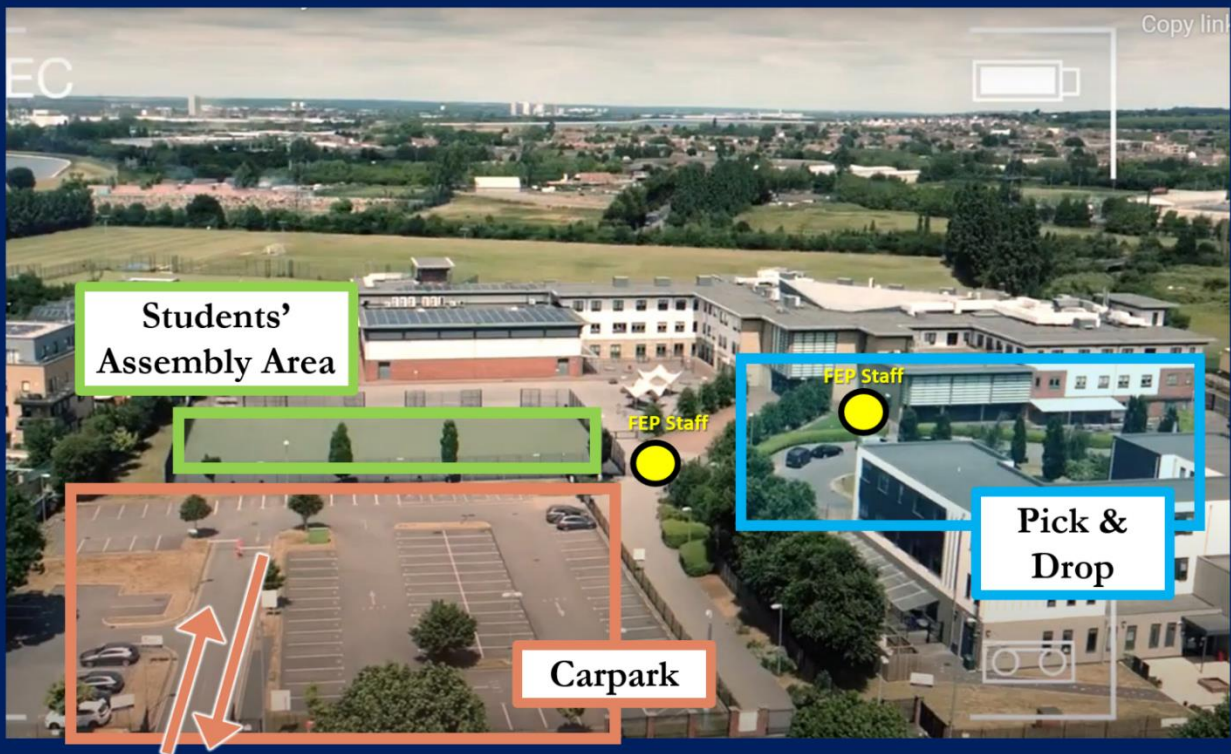

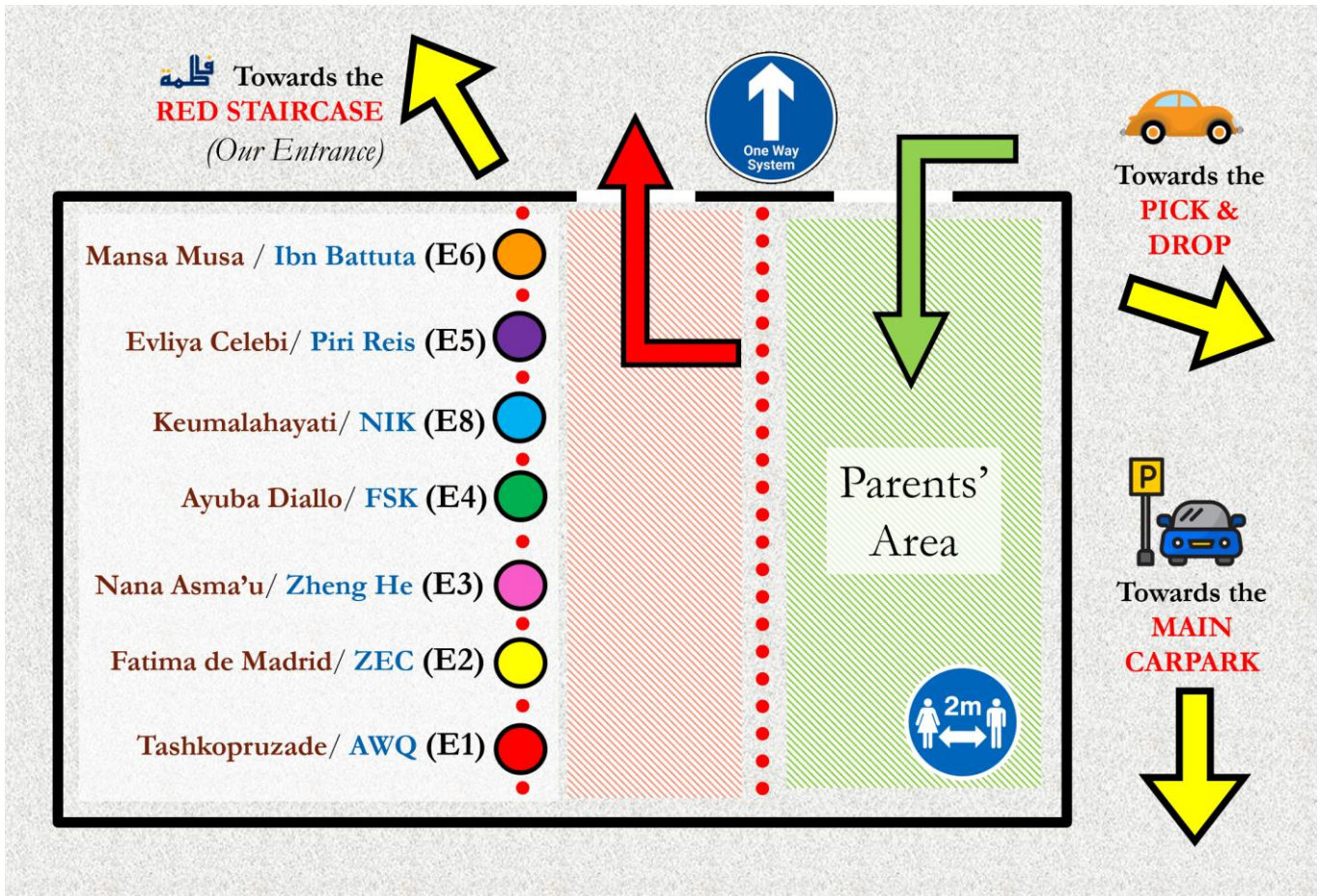

Policy agreed on behalf of Staff

Signed:

(Ustadh Hamid Mahmood)
Head Teacher

Date: 31 / 08 / 2022